

Studio A Rate Card



Power: 4 wall boxes with feeds including:

Pal PGM output from second floor control room
Black and Burst reference
2 x Video tielines to equipment room
2 x Floor monitors
2 x Plasma 42" television
2 x Autocue
4 x Mic feeds to second floor sound control room
4 x Audio tielines to equipment room (XLR male and female)
2 x Presenter talkback positions
2 x Lemo triax connectors
Floor manager talkback position

Control Suite:

1 x Monitor stack with: 12 x JVC TM-H150CG monitors
2 x JVC TM-H1900 monitors
1 x Leitch 8" timecode clock
10 x TSL UMDs (with tally lights)

1 x PCR desk with:

1 x Ross video 16 input SDI vision mixer
1 x Hamlet Video SDI waveform monitor
3 x Sony OCPs for D50 cameras
1 x JVC TM-H150CG monitor
1 x Dim/Cut panel for speakers
3 x Talkback positions
3 x Matrix control panels
2 x Genelec 8030 speakers

1 x Rear desk with:

1 x Talkback position
Pinnacle Deko 550 character generator - Thunderbrowse.

Equipment Room:
3 x racks with:

Sony DSR-1800AP DVcam VTR c/w SDI inputs/outputs
Sony DSR-1600AP DVcam editing player c/w SDI outputs
Teltronix SPG300 sync pulse generator
Evertz 5010 timecode generator
Autocue PC
Triax patch panel (Lemo connectors)
3 x Sony CCU-TX50P (Lemo connectors)
1 x Trilogy Orator 18 x 18 talkback matrix
1 x Leitch Panacea 16 x 16 SDI matrix
1 x JVC-TM150CG moitor
1 x Matrix control panel
1 x Talkback position
3 x Vistek crates of assorted 'glue'

Studio A information sheet

Studio A is a professional black out sound proofed TV studio. Comes with a fully equipped state-of-the-art control suite. Perfect for small/medium sized productions or as a location.

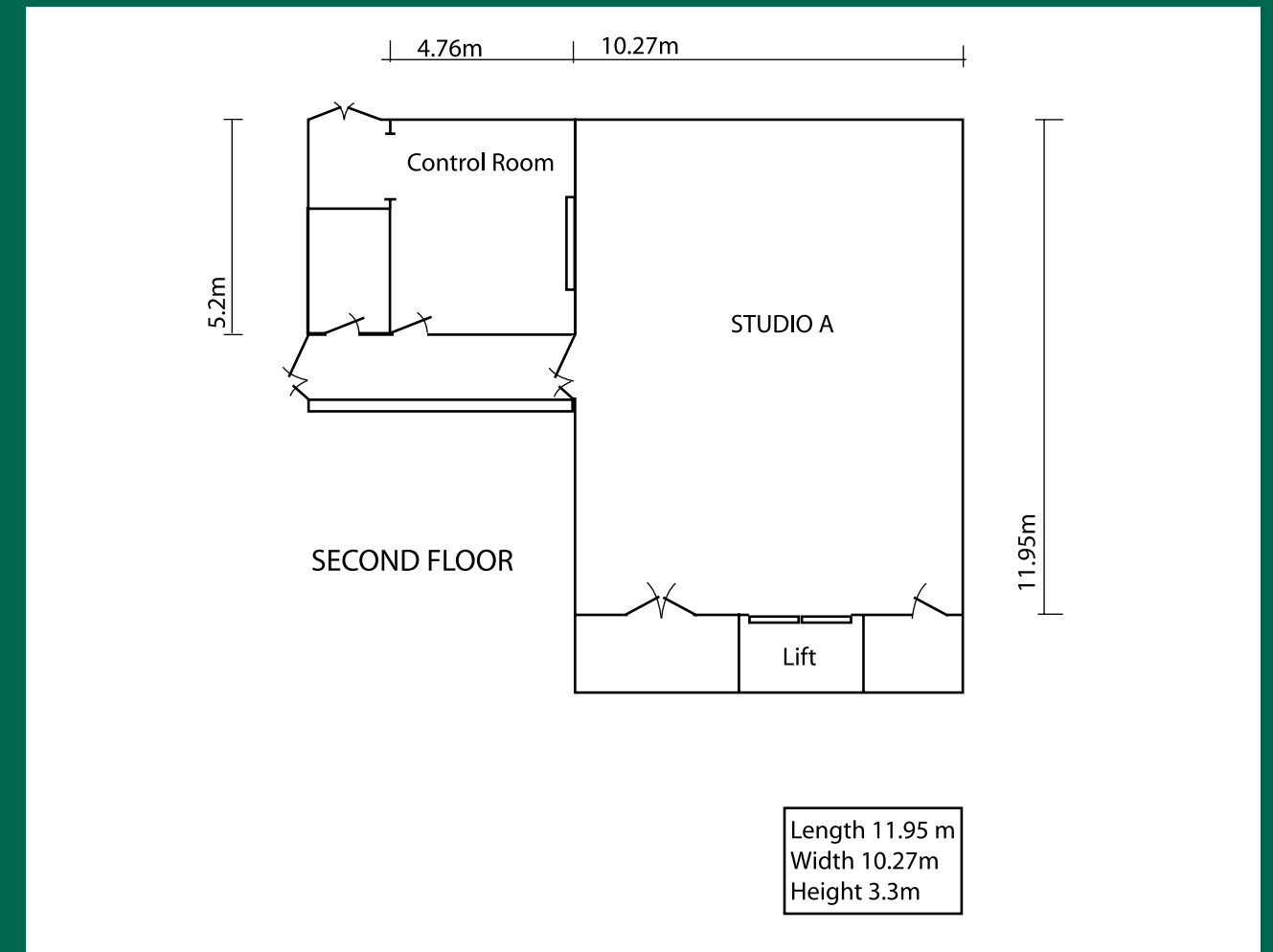

Dimensions:

Floor Area: 10m x 11m (32'81" x 36'09")
Lift Access Door: 2.4m x 1.8m (8' x 6')
Drop to drape rail: 3.3m (10'9")
Drop to lighting rig: 3.5m (11'5")

In addition to this we have:

Sound Control room and Sound Booth
Additional studio/camera equipment for hire
20 x G5 Mac edit stations running FCP production suite
40 x PC edit stations running Premier Pro production suite

Rates: £500.00 per day

Please note that this figure can be negotiated.



Contact:
Nicola Holmes:
nicola.holmes@wlc.ac.uk
or Kulvinder Madahar:
020 8231 6055

Studio B Rate Card



Power: 4 wall boxes with feeds including:

Pal PGM output from first floor control room
Black and Burst reference
4 x Video tielines to equipment room
2 x Mic feeds to first floor control room
2 x Mic feeds to second floor sound control room
4 x Audio tielines to equipment room (XLR male and female)
Floor manager talkback position
Presenter talkback position
1 x Lemo triax connector (patch in equipment room)

Control Suite:

1 x Monitor stack with: 2 x JVC TM-H150CG monitors
2 x Panasonic Monitors 2 x Genelec 8030 speakers
1 x Leitch 12" timecode clock

1 x PCR desk with:

Soundcraft M12 audio mixer
Focusrite 8 ch Mic amp
Sony MDS-JB980 Mini Disk Recorder
Denon DRM-555 tape deck
Sony CDP-XE200 CD deck
Panasonic AG-MX70 vision mixer
4 x 9" Monitors
2 x Talkback positions
1 x Matrix control panel

Studio B information sheet

Studio B is ideal for stills photography shoots; comes with black and white back drops. It is perfect for small/medium sized productions. Studio B links up to the main studio on the second floor.

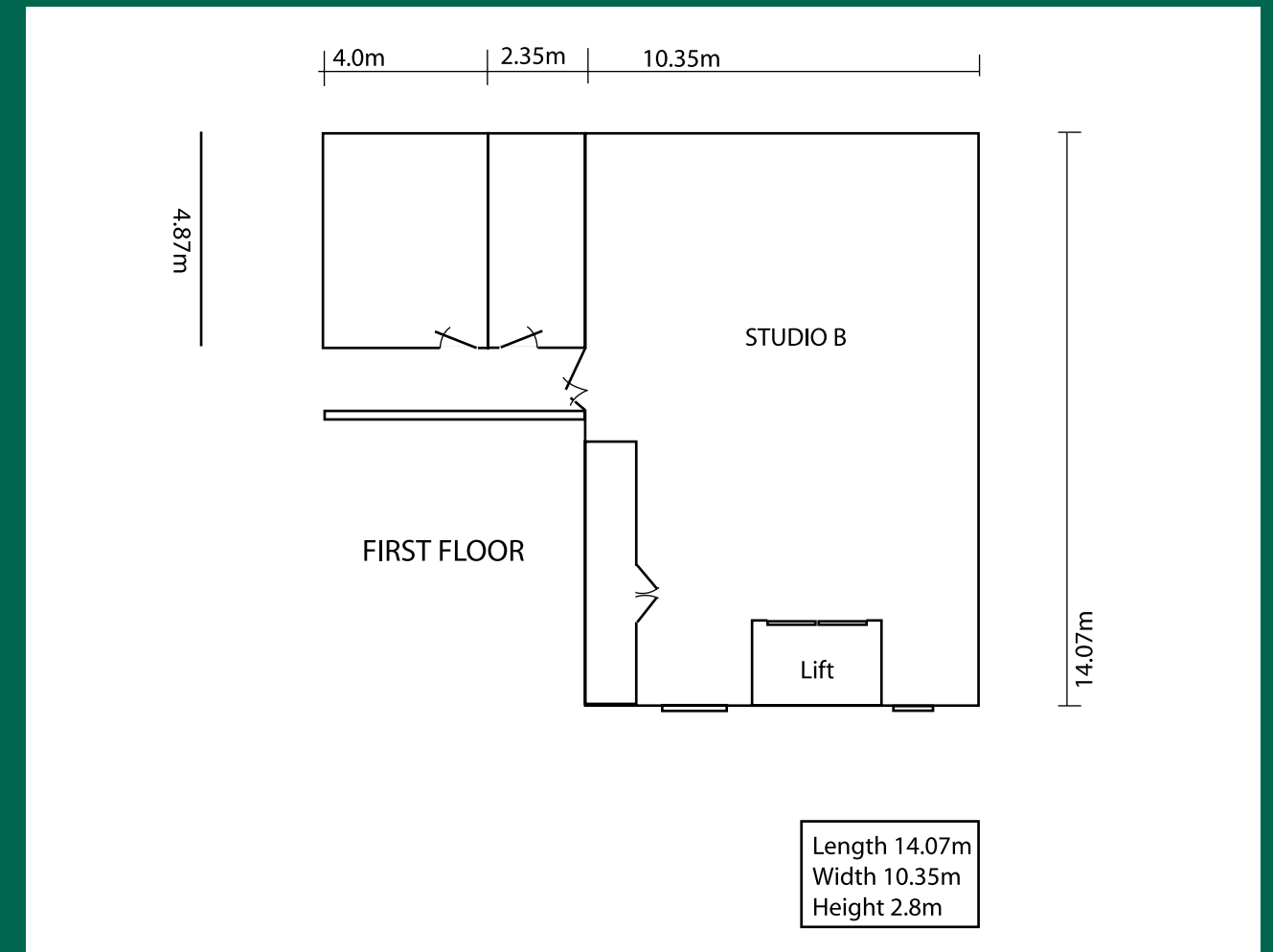

Dimensions:

Floor Area: 10m x 11m (32'81" x 36'09")
Lift Access Door: 2.4m x 1.8m (8' x 6')

In addition to this we have:

Sound Control room and Sound booth
Additional studio/camera equipment for hire
20 x G5 Mac edit stations running FCP production suite
40 x PC edit stations running Premier Pro production suite

Rates: £500.00 per day

Please note that this figure can be negotiated.



Contact:
Nicola Holmes:
nicola.holmes@wlc.ac.uk
or Kulvinder Madahar:
020 8231 6055

Studio A Sound Production Suite



Studio A has a state-of-the-art sound performance booth and control suite, perfect for voice overs, ADR and music recording space.

Sound Booth Dimensions: Floor Area: 10m x 11m (32'81" x 36'09")
 Power: 1 wall boxes with feeds including: 12 x Mic feeds to first floor control room
 5 x Mic stands with pop sheilds
 Voice Booth

Sound Control: 1 x production desk with:
 Yamaha DM1000 (v2) 48 channel audio mixer
 Denon DN-C635 CD player
 Tascam 3 head cassette recorder
 1 x Talkback position
 1 x Matrix control panel
 2 x Genelec 8030 speakers
 1 x Leitch 12" timecode clock

Rates: £200.00 per day

Please note that this figure can be negotiated.

Studio B designed for music design has brand new high end production equipment. It comes complete with decks, keyboard and software to transpose the music/effects to the filmed image.

Sound Booth Dimensions: 10m x 11m (32'81" x 36'09")
 Power: 13 Amp wall plugs
 Sound Design: 1 x G5 Mac running: Pro Tools (with digi 002 rack firewire interface)
 Logic Pro 7.1
 Sibelius 4
 Yamaha CLP 270R weighted keyboard
 Stanton final scratch (wired into 2x Numark DXM Pro/Numark TT500)
 Final Cut Pro production suite

Rates: £200.00 per day

Please note that this figure can be negotiated.

Studio B Sound Production Suite

Additional Equipment



Item	Commercial Rate		Grant funded/non-profit making organisations – 25% discount		In-house projects – 50% discount	
	Per Day	Per Week	Per Day	Per Week	Per Day	Per Week
Sand bags	£5.00	£22.50	£3.75	£16.80	£2.50	£11.25
Manfrotto 501 video head tripods	£15.00	£67.50	£11.50	£51.75	£7.50	£33.75
Cannon XL1s camcorder with MA200 4 ch XLR beach box	£80.00	£360.00	£60.00	£270.00	£40.00	£180.00
42" lastolite reflectors	£5.00	£22.50	£3.75	£16.80	£2.50	£11.25
Senheiser radio mics	£10.00	£45.00	£7.50	£33.75	£5.00	£22.50
Senheiser studio radio mic sets	£10.00	£45.00	£7.50	£33.75	£5.00	£22.50
Senheiser rifle mics (with cradle, wind shield and boom)	£15.00	£67.50	£11.50	£51.75	£7.50	£33.75
Nikon D70s digital stills camera	£60.00	£270.00	£45.00	£202.50	£30.00	£135.00
Sony Z1E HD Camcorder	£75.00	£337.50	£56.25	£253.10	£37.50	£168.75
Sony 9" field monitor	£25.00	£112.50	£18.75	£84.40	£12.50	£56.25
Spider Dolly	£10.00	£45.00	£7.50	£33.75	£5.00	£22.50
Straight SSE track	£4.00 per foot	£18.00	£3.00	£13.50	£2.00	£9.00
¼ Curve SSE track	£25.00	£112.50	£18.75	£84.40	£12.50	£56.25
9' x 6' Lastolite green screen	£15.00	£67.50	£11.50	£51.75	£7.50	£33.75
JVC TM-A210G Floor monitor on unicol columns	£50.00	£225.00	£37.50	£168.75	£25.00	£112.50
Manfrotto tripods c/w Pan and tilt head, 2 pan bars, skid.	£25.00	£112.50	£18.75	£84.40	£12.50	£56.25
Panasonic TH-42PWD8BK 42" Plasma screen on Unicol column	£80.00	£360.00	£60.00	£270.00	£40.00	£180.00
Kramer SP-11 PAL video colour corrector for Plasma	£20.00	£90.00	£15.00	£67.50	£10.00	£45.00
Vinten Tripods c/w Pan and tilt head, 2 pan bars, skid with cable guard	£20.00	£90.00	£15.00	£67.50	£10.00	£45.00
Sony DXC-D50WSPL Triax Camera c/w 5" mono viewfinder. Switchable 16:9/4:3	£180.00	£810.00	£135.00	£607.50	£90.00	£405.00
Fujinon A20x8.6BRM Lens, 2/3" professional ENG, manual focus, servo zoom	£85.00	£382.50	£63.75	£286.85	£42.50	£191.25
Beyer DT109 Headsets for Camera operators	£6.00	£27.00	£4.50	£20.25	£3.00	£13.50
AutoCue system	£250.00	£1125.00	£187.50	£843.75	£125.00	£562.50

- Please note that the daily rate is based on a 9 hour day.
- The weekly rate is based on a 5 day week (incl. 10% discount)
- If kit is required over the weekend, then the charge is based upon the normal daily rate.
- We can also offer discounted kit packages. (please email with any queries)



Contact:
 Nicola Holmes:
 nicola.holmes@wlc.ac.uk
 or Kulvinder Madahar:
 020 8231 6055



Contact:
 Nicola Holmes:
 nicola.holmes@wlc.ac.uk
 or Kulvinder Madahar:
 020 8231 6055